

PREPARED FOR:
TRICIA FORBECK
KEEFE REAL ESTATE
LAKE GENEVA, WI.

PLAT OF SURVEY

- OF -
LOT 3, BLOCK 12 OF GLENWOOD SPRINGS SUBDIVISION,
LOCATED IN THE VILLAGE OF FONTANA-ON-GENEVA-LAKE,
WALWORTH COUNTY, WISCONSIN.

PATHFINDER SURVEYING INC.
(formerly)
J.K. SURVEYING INC.
P.O BOX 322
LAKE GENEVA, WI. 53147
WWW.PATHFINDERSURVEYING.NET
262-248-8303

40.85'

DUNLAP AVENUE

N 74°04'34" W 41.92'
(41.90')

asphalt

corner falls
under rock
in asphalt

fence on line

stair case
0.5' westerly

S 00°46'01" E 98.99'
(99.00')

9.93'

18.72'

9.80'

7.95'

11.90'

13.00'

10.07'

25.49'

4.76'

N 89°18'00" E

(40.0')

WALNUT PLACE
(10' WIDE)

concrete

deck

existing residence
and enclosed deck

N 00°44'16" W 87.00'
(87.00')

4.43'

37.43'

4.36'

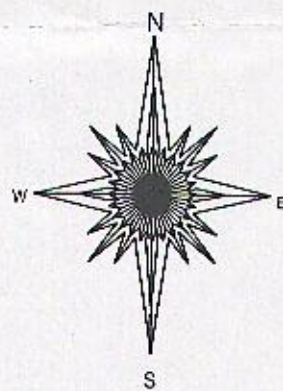

BASIS OF BEARING OF THIS PLAT: THE
NORTH LINE OF WALNUT PL. WAS
ASSUMED TO BEAR N89°18'00" E.

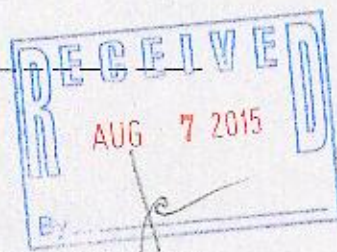

- () = recorded as
- = found iron bar
- = found iron pipe
- = set iron pipe
- = set iron bar

SCALE 1" = 10'

JOB # 15-138

TAX ID # SGS00061

I hereby certify that I have surveyed the above-described property and the
above map is a true representation thereof and shows the size and
location of the property, its exterior boundaries, the location and
dimensions of all structures thereon, fences, appurtenant easements and
roadways and visible encroachments if any.

This survey is made for the present owners of the property, and those who
purchase, mortgage, or guarantee the title thereto, within one year from
the date hereof.

DATED THIS 13TH DAY OF MAY, 2015.

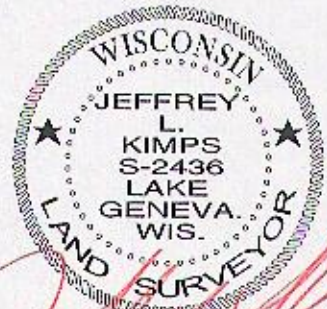
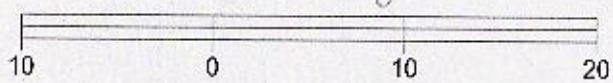

JEFFREY L. KIMPS S - 2436
Wisconsin Registered Land Surveyor
(original if signed in red)

005-3147